

SCALE: 1:1
UNIT:mm

版本	修改内容
2	增加备注4, 5
3	COVER孔修正
4	修改PIN定義

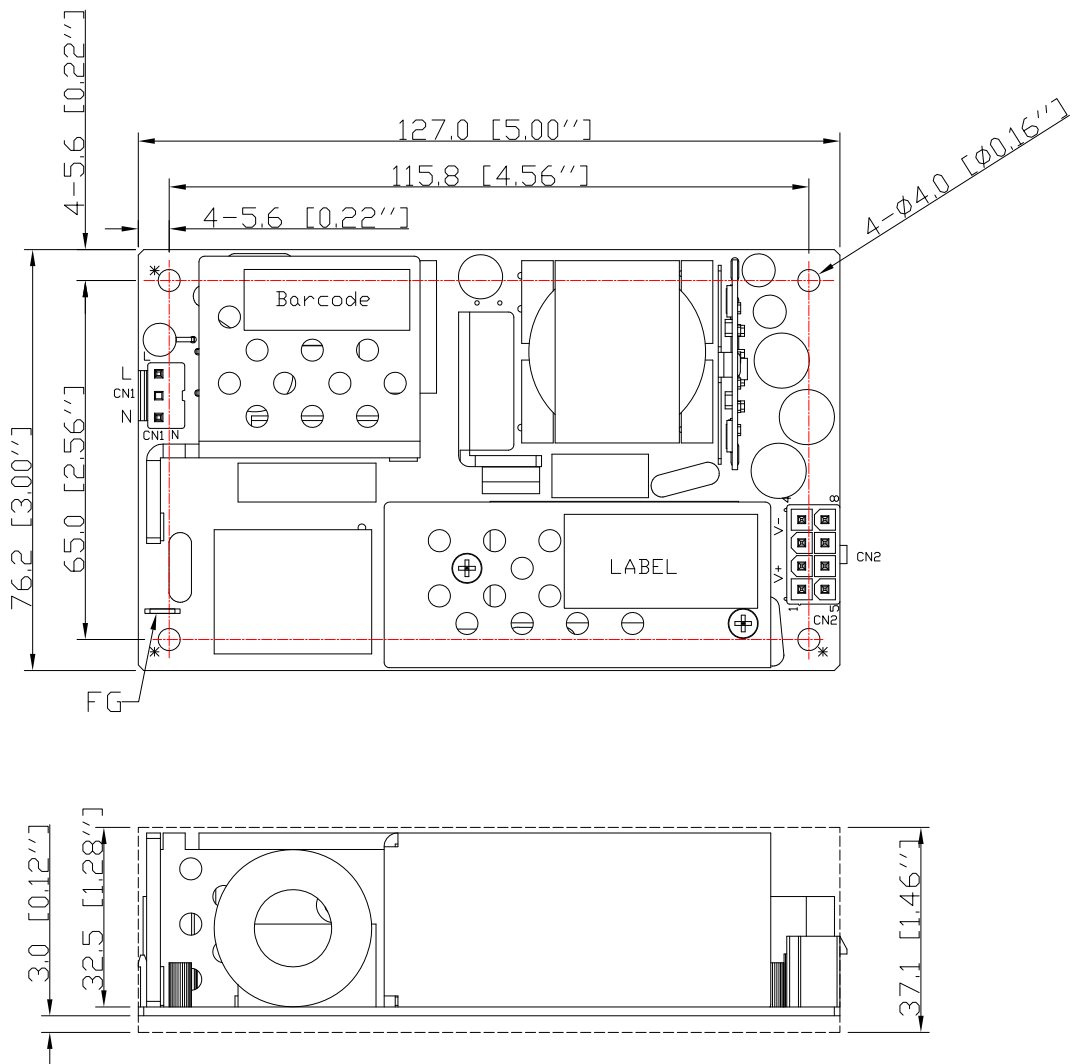

Notes:

1. Dimension (LxWxH) : 127X76. 2X37. 1mm
2. AC input (CN1) : JST B2P3-VH or EQU

PIN1	N
PIN2	NC
PIN3	L

3. DC output (CN2) : JTW C4201WV0-2x4P or EQU

PIN1,2,5,6	Vout+
PIN3,4,7,8	Vout-

4. Ground tab is 6.35 x 0.8 mm (0.25" x 0.032") fast-on male terminal.
5. To ensure compliance with level B emissions, connect the three "*" marked mounting holes with metallic standoffs to the chassis.
6. 螺丝孔位公差±0.3, 其他尺寸公差±0.5

P/N.: 90C4504100

MODEL NO. :FSP450-H35-A54	OUTLINE	SHEET: 1 OF 1	REV:4
R&D(SH)	P E	DRAWN	DATE
		WEIW	20/DEC/24'